

JUMO GmbH & Co. KG
 Delivery address: Mackenrodtstraße 14,
 36039 Fulda, Germany
 Postal address: 36035 Fulda, Germany
 Phone: +49 661 6003-0
 Fax: +49 661 6003-607
 E-mail: mail@jumo.net
 Internet: www.jumo.net

JUMO Instrument Co. Ltd.
 JUMO House
 Temple Bank, Riverway
 Harlow - Essex CM20 2DY, UK
 Phone: +44 1279 63 55 33
 Fax: +44 1279 63 52 62
 E-mail: sales@jumo.co.uk
 Internet: www.jumo.co.uk

JUMO Process Control, Inc.
 8 Technology Boulevard
 Canastota, NY 13032, USA
 Phone: 315-697-JUMO
 1-800-554-JUMO
 Fax: 315-697-5867
 E-mail: info@jumo.us
 Internet: www.jumo.us



Contact dial thermometer

Particularities

- Temperature controller with actual value display as panel-mounting or add-on device
- Stainless steel case with bayonet lock
- Class 1.5
- Protection class IP 53
- Case sizes Ø: 60 mm, 80 mm and 100 mm
 Front frame: 72x72 mm and 96x96 mm

Brief description

Contact dial thermometer are devices with actual value display for temperature measurement, control and monitoring and can be used universally.

The temperature depending volume change in a measuring system filled with liquid or the temperature depending pressure change in a measuring system filled with gas is converted to a rotational movement of the actual value indicator by a bourdon tube, no transmission gear is required. The micro switch is actuated by the rotational movement of the indicator shaft via a tap system.



Technical Data

Case and front frame	Stainless steel (1.4301)
Cover cap	Plastic (PA6), gray, UV stabilized
Protection type	IP 51 as per DIN EN 60529 (IP 53 with extra code 401)
Front pane	Acryl glass (PMMA)
Chassis	Aluminum (3.2582.05)
Scale	white, labeled in black
Display	Class 1.5 similar to DIN EN 13190
Anti-kink spring	for devices with long-distance line on the case and the temperature probe
Set point value setting	by set point controller in the front window
Display correction	on the rear
Limit value temperatures	for transport and storage -30°C...+70°C (for display range -40...+40°C up to max. 50°C; -30...+50°C up to max. 60°C)
Rated position	any

JUMO GmbH & Co. KG
 Delivery address: Mackenrodtstraße 14,
 36039 Fulda, Germany
 Postal address: 36035 Fulda, Germany
 Phone: +49 661 6003-0
 Fax: +49 661 6003-607
 E-mail: mail@jumo.net
 Internet: www.jumo.net

JUMO Instrument Co. Ltd.
 JUMO House
 Temple Bank, Riverway
 Harlow - Essex CM20 2DY, UK
 Phone: +44 1279 63 55 33
 Fax: +44 1279 63 52 62
 E-mail: sales@jumo.co.uk
 Internet: www.jumo.co.uk

JUMO Process Control, Inc.
 8 Technology Boulevard
 Canastota, NY 13032, USA
 Phone: 315-697-JUMO
 1-800-554-JUMO
 Fax: 315-697-5867
 E-mail: info@jumo.us
 Internet: www.jumo.us



Technical Data

Display range (AB)	Display range in °C	Measuring range in °C	Tolerance in °C
469	-20...+40	-30...+30	1.5
643	-20...+120	-20...+120	3.0
807	0...+60	+10...+50	1.5
814	0...+100	+10...+90	1.5
818	0...+120	+20...+100	3.0
832	0...+200	+20...+180	3.0
840	0...+300	+30...+270	6.0
848	0...+400	+50...+350	6.0
854	0...+500	+50...+450	8.0
848	0...+600	+100...+500	10.0

	Liquid filling	Gas filling
Measuring system	Display range (AB) ≤ 350°C	Display range (AB) ÷ 400°C
Time behavior	approx. 12 s, measured in water, with a probe Ø of 6 mm made of Cu.	approx. 4 s, measured in oil, with a probe Ø of 10 mm made of stainless steel.
Ambient temperature influence effect	In % of the display range (referring to the deviation from the reference value +23°C)	
on case	0.15% of the display range per K ambient temperature change	0.05% of the display range per K ambient temperature change
on long-distance line (per m)	0.03% of the display range per K ambient temperature change	no influence
	Higher ambient temperature – higher temperature display – lower switching point	
Anti-kink spring	for devices with long-distance line on the case and the temperature probe	
Set point value setting	by set point controller in the front window	
Display correction	on the rear	
Limit value temperatures	for transport and storage -30°C...+70°C (for display range -40...+40°C up to max. 50°C; -30...+50°C up to max. 60°C)	
Rated position	any	

	standard	Extra code (TZ) 650
Electric contact	Single-pole micro switch with mechanically actuate change-over contact	
Type of contact		
Contact rating	AC 230V, +10/-15%, 48...63Hz, cos φ = 1 (0.6)	
	5 (1.5) A	10 (3) A
Hysteresis	approx. 1.5% of the display range	1.5 to 3% of the display range
Switching point accuracy	± 0.5% of the display range referring to the switch-off point with rising temperature	
Switching reliability	To ensure a high switching reliability, we recommend a minimum voltage of 24 V and a minimum current of 100 mA	

	standard	Design 02 and 22	Design 10, 23 and TZ 426	Case Ø 60 mm
Electrical connection	Screw-type terminals, connection cross section up to 2.5 mm ²	Connection cable 0.5 m with screw-type terminals	Cover cap with cable screw-connection, suitable for cable Ø from 6.5 to 13 mm	Cover cap with cable screw-connection, suitable for cable Ø from 8 to 10 mm

JUMO GmbH & Co. KG
 Delivery address: Mackenrodtstraße 14,
 36039 Fulda, Germany
 Postal address: 36035 Fulda, Germany
 Phone: +49 661 6003-0
 Fax: +49 661 6003-607
 E-mail: mail@jumo.net
 Internet: www.jumo.net

JUMO Instrument Co. Ltd.
 JUMO House
 Temple Bank, Riverway
 Harlow - Essex CM20 2DY, UK
 Phone: +44 1279 63 55 33
 Fax: +44 1279 63 52 62
 E-mail: sales@jumo.co.uk
 Internet: www.jumo.co.uk

JUMO Process Control, Inc.
 8 Technology Boulevard
 Canastota, NY 13032, USA
 Phone: 315-697-JUMO
 1-800-554-JUMO
 Fax: 315-697-5867
 E-mail: info@jumo.us
 Internet: www.jumo.us



Dimensions

Type:

608520/0280

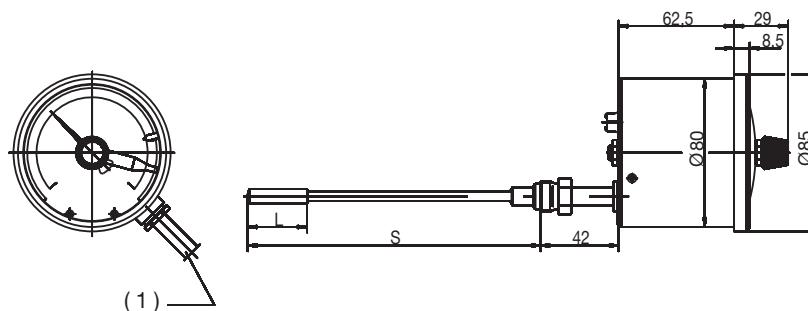

(1) Connection line 0.6 m long with screw terminal

Type:

608520/0210

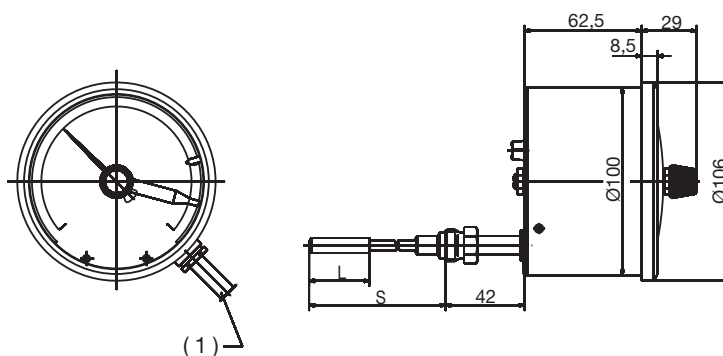

(1) Connection line 0.6 m long with screw terminal

Type:

608520/1080

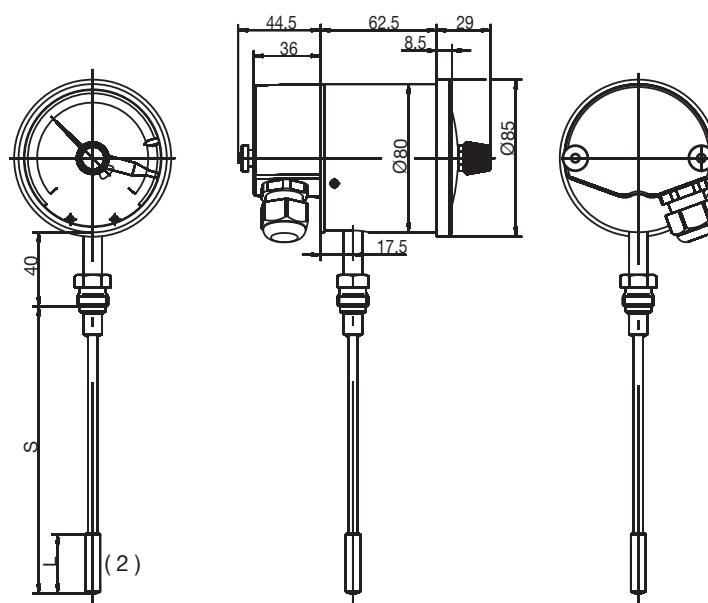

(2) active probe dimension

JUMO GmbH & Co. KG

Delivery address: Mackenrodtstraße 14,
36039 Fulda, Germany
Postal address: 36035 Fulda, Germany
Phone: +49 661 6003-0
Fax: +49 661 6003-607
E-mail: mail@jumo.net
Internet: www.jumo.net

JUMO Instrument Co. Ltd.

JUMO House
Temple Bank, Riverway
Harlow - Essex CM20 2DY, UK
Phone: +44 1279 63 55 33
Fax: +44 1279 63 52 62
E-mail: sales@jumo.co.uk
Internet: www.jumo.co.uk

JUMO Process Control, Inc.

8 Technology Boulevard
Canastota, NY 13032, USA
Phone: 315-697-JUMO
1-800-554-JUMO
Fax: 315-697-5867
E-mail: info@jumo.us
Internet: www.jumo.us

**Type:**

608520/1010

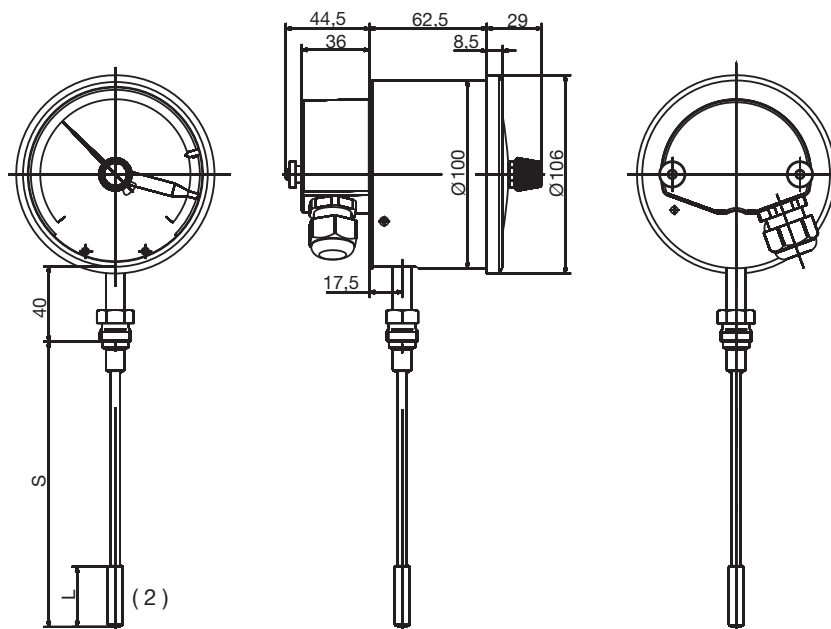

(2) active probe dimension

Type:

608520/2060

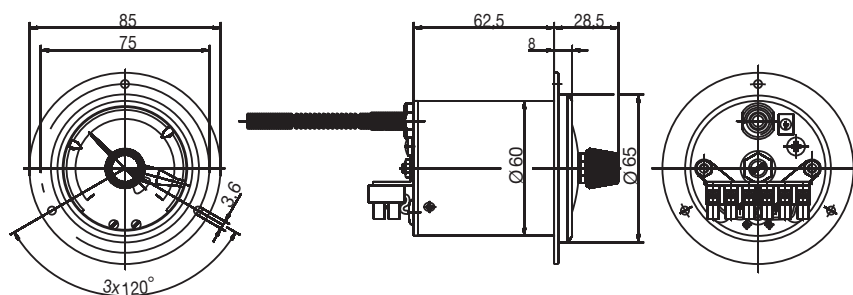

Panel cut-out for case
 $\varnothing 60 \text{ mm} = 62^{+0.5}_{-0} \text{ mm}$

Type:

608520/2080

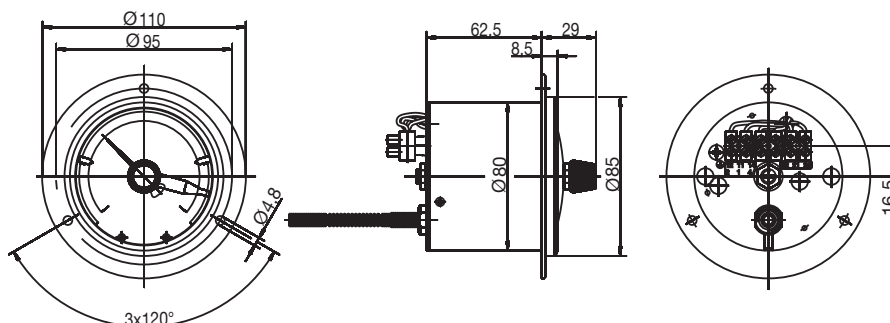

Panel cut-out for case
 $\varnothing 80 \text{ mm} = 62^{+0.5}_{-0} \text{ mm}$

JUMO GmbH & Co. KG

Delivery address: Mackenrodtstraße 14,
36039 Fulda, Germany
Postal address: 36035 Fulda, Germany
Phone: +49 661 6003-0
Fax: +49 661 6003-607
E-mail: mail@jumo.net
Internet: www.jumo.net

JUMO Instrument Co. Ltd.

JUMO House
Temple Bank, Riverway
Harlow - Essex CM20 2DY, UK
Phone: +44 1279 63 55 33
Fax: +44 1279 63 52 62
E-mail: sales@jumo.co.uk
Internet: www.jumo.co.uk

JUMO Process Control, Inc.

8 Technology Boulevard
Canastota, NY 13032, USA
Phone: 315-697-JUMO
1-800-554-JUMO
Fax: 315-697-5867
E-mail: info@jumo.us
Internet: www.jumo.us

**Type:**

608520/2010

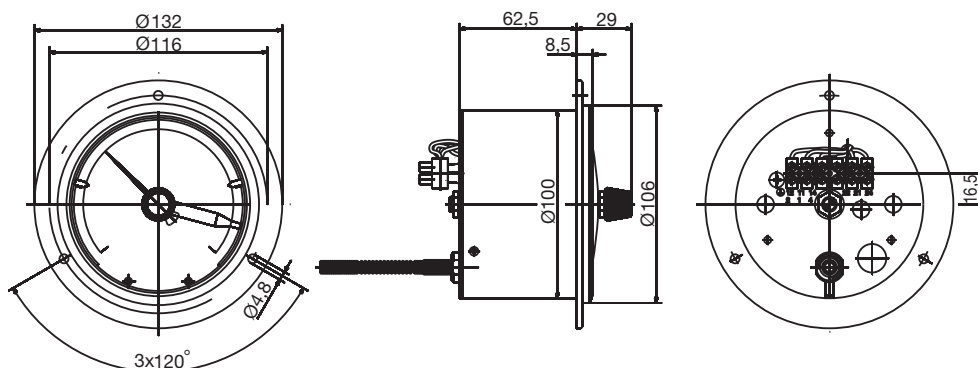

Panel cut-out for case
 $\varnothing 100 \text{ mm} = 100^{+0.5}_{-0} \text{ mm}$

Type:

608520/2160

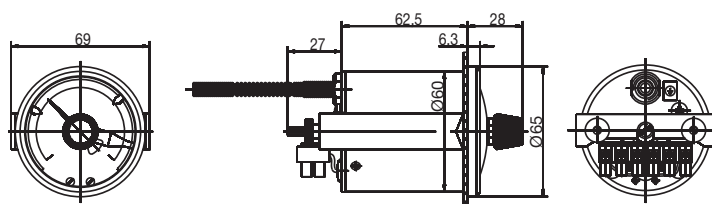

Panel cut-out for case
 $\varnothing 60 \text{ mm} = 62^{+0.5}_{-0} \text{ mm}$

Type:

608520/2180

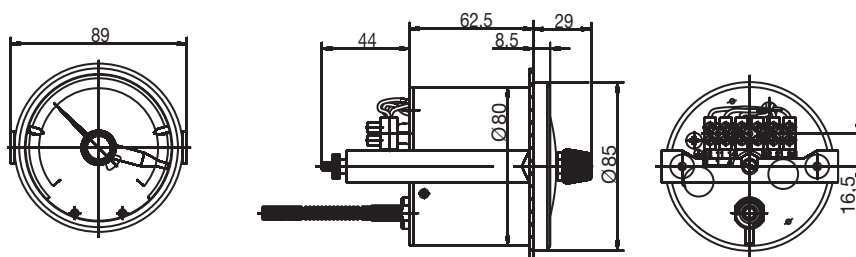

Panel cut-out for case
 $\varnothing 80 \text{ mm} = 62^{+0.5}_{-0} \text{ mm}$

Type:

608520/2110

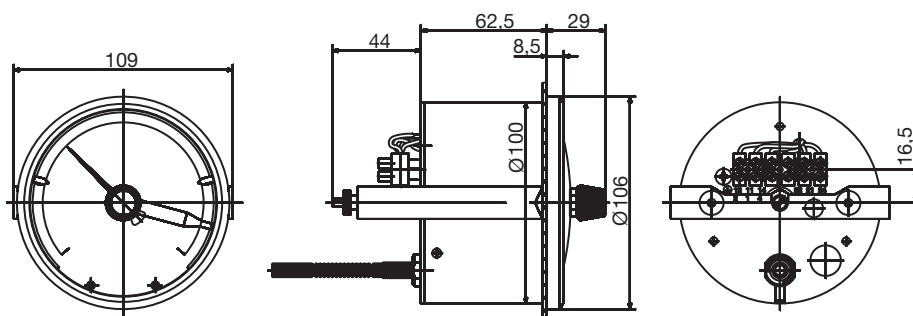

Panel cut-out for case
 $\varnothing 100 \text{ mm} = 100^{+0.5}_{-0} \text{ mm}$

JUMO GmbH & Co. KG

Delivery address: Mackenrodtstraße 14,
36039 Fulda, Germany
Postal address: 36035 Fulda, Germany
Phone: +49 661 6003-0
Fax: +49 661 6003-607
E-mail: mail@jumo.net
Internet: www.jumo.net

JUMO Instrument Co. Ltd.

JUMO House
Temple Bank, Riverway
Harlow - Essex CM20 2DY, UK
Phone: +44 1279 63 55 33
Fax: +44 1279 63 52 62
E-mail: sales@jumo.co.uk
Internet: www.jumo.co.uk

JUMO Process Control, Inc.

8 Technology Boulevard
Canastota, NY 13032, USA
Phone: 315-697-JUMO
1-800-554-JUMO
Fax: 315-697-5867
E-mail: info@jumo.us
Internet: www.jumo.us

**Type:**

608520/2280

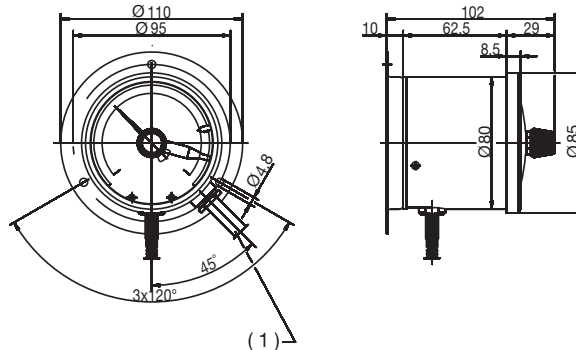

(1) Connection line 0.6 m long with screw terminal

Type:

608520/2210

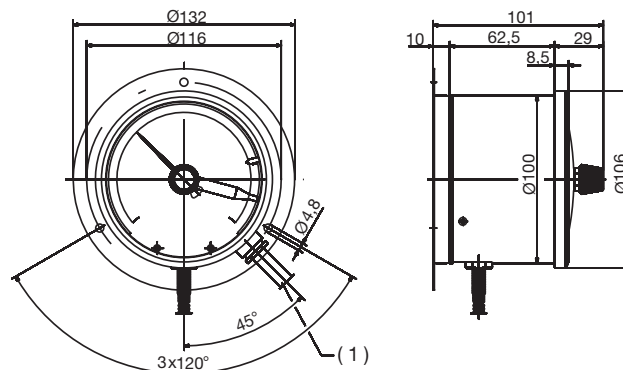

(1) Connection line 0.6 m long with screw terminal

Type:

608520/2380

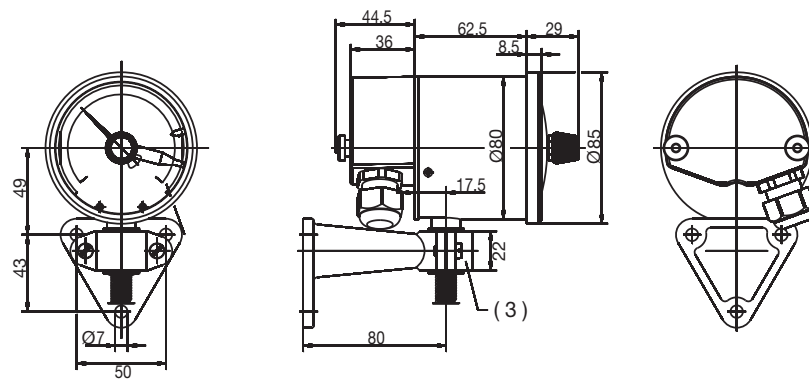

(3) Spigot Ø 20 mm

JUMO GmbH & Co. KG

Delivery address: Mackenrodtstraße 14,
36039 Fulda, Germany
Postal address: 36035 Fulda, Germany
Phone: +49 661 6003-0
Fax: +49 661 6003-607
E-mail: mail@jumo.net
Internet: www.jumo.net

JUMO Instrument Co. Ltd.

JUMO House
Temple Bank, Riverway
Harlow - Essex CM20 2DY, UK
Phone: +44 1279 63 55 33
Fax: +44 1279 63 52 62
E-mail: sales@jumo.co.uk
Internet: www.jumo.co.uk

JUMO Process Control, Inc.

8 Technology Boulevard
Canastota, NY 13032, USA
Phone: 315-697-JUMO
1-800-554-JUMO
Fax: 315-697-5867
E-mail: info@jumo.us
Internet: www.jumo.us

**Type:**

608520/2310

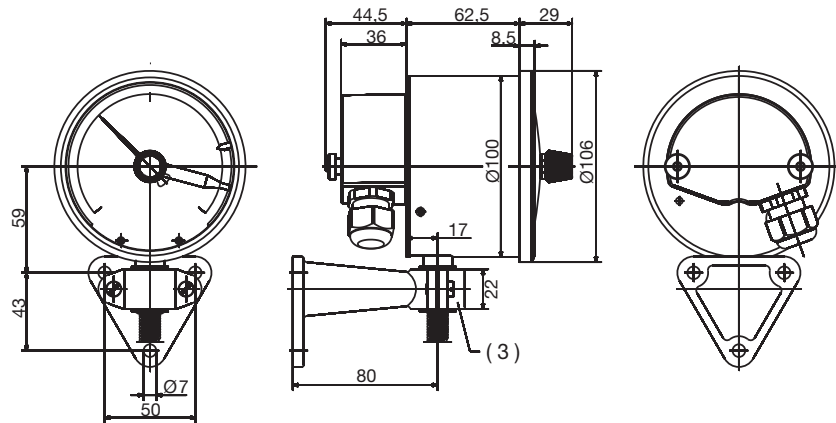

(3) Spigot Ø 20 mm

Type:

608520/2572

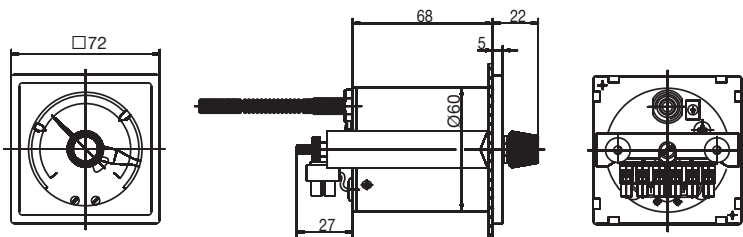

Panel cut-out for front frame
72 x 72 mm = Ø 62^{+0.5} mm

Type:

608520/2596

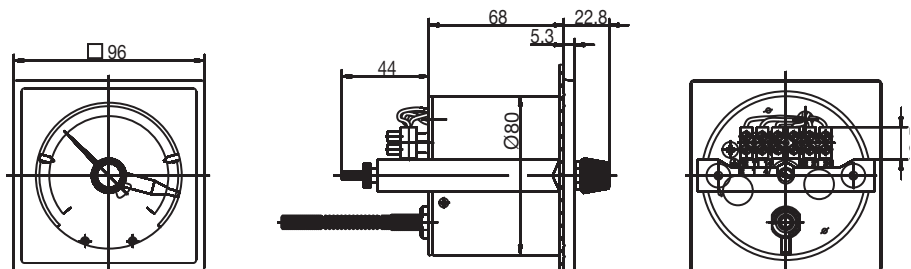

Panel cut-out for front frame
96 x 96 mm = Ø 82^{+0.5} mm oder
96 x 96 mm = 92 x 92^{+0.5} mm (TZ 460)

JUMO GmbH & Co. KG

Delivery address: Mackenrodtstraße 14,
36039 Fulda, Germany
Postal address: 36035 Fulda, Germany
Phone: +49 661 6003-0
Fax: +49 661 6003-607
E-mail: mail@jumo.net
Internet: www.jumo.net

JUMO Instrument Co. Ltd.

JUMO House
Temple Bank, Riverway
Harlow - Essex CM20 2DY, UK
Phone: +44 1279 63 55 33
Fax: +44 1279 63 52 62
E-mail: sales@jumo.co.uk
Internet: www.jumo.co.uk

JUMO Process Control, Inc.

8 Technology Boulevard
Canastota, NY 13032, USA
Phone: 315-697-JUMO
1-800-554-JUMO
Fax: 315-697-5867
E-mail: info@jumo.us
Internet: www.jumo.us



Order details

**Order
code**





(1)

Basic type

608520	Mechanical Contact dial thermometer, class 1.5
608550	Mechanical Contact dial thermometer, class 1.5, Transformer version (only basic type extension 1080)

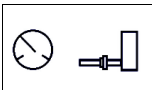
(2) **Basic type extensions**

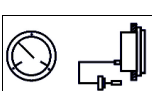
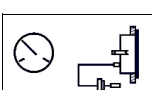
Case size Ø

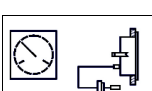
0280	Design 02		80 mm
0210			100 mm
1080	Design 10		80 mm
1010			100 mm
2060	Design 20		60 mm
2080			80 mm
2010			100 mm
2160	Design 21		60 mm
2180			80 mm
2110			100 mm
2280	Design 22		80 mm
2210			100 mm
2380	Design 23		80 mm
2310			100 mm
2572	Design 25		Case size □
2596			72 x 72 mm
			96 x 96 mm

(3) **Display range in °C**

469	-40...+40
643	-20...+120
807	0...+60
814	0...+100
818	0...+120
832	0...+200
840	0...+300
848	0...+400
854	0...+500
858	0...+600

JUMO GmbH & Co. KG

Delivery address: Mackenrodtstraße 14,
36039 Fulda, Germany
Postal address: 36035 Fulda, Germany
Phone: +49 661 6003-0
Fax: +49 661 6003-607
E-mail: mail@jumo.net
Internet: www.jumo.net

JUMO Instrument Co. Ltd.

JUMO House
Temple Bank, Riverway
Harlow - Essex CM20 2DY, UK
Phone: +44 1279 63 55 33
Fax: +44 1279 63 52 62
E-mail: sales@jumo.co.uk
Internet: www.jumo.co.uk

JUMO Process Control, Inc.

8 Technology Boulevard
Canastota, NY 13032, USA
Phone: 315-697-JUMO
1-800-554-JUMO
Fax: 315-697-5867
E-mail: info@jumo.us
Internet: www.jumo.us











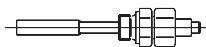

**Order code****(4) Long-distance line type (FL) ^a**

00	Without (with rigid connection)
02	FL 02 Cu long-distance line with Cu textile braiding, approx. Ø 2.5 mm (up to AB limit value +300°C)
11	FL 11 Cu long-distance line with PE jacketing, approx. Ø 3.5 mm (up to AB limit value +120°C)
17	FL 17 Stainless steel long-distance line, approx. Ø 1.5 mm
21	FL 21 Cu long-distance line, approx. Ø 1.0 mm (up to AB limit value +300°C)

(5) Long-distance line ^b

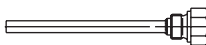
0	Without (with rigid connection)
1000	1000 mm
2000	2000 mm
3000	3000 mm
4000	4000 mm
5000	5000 mm
...	Special length (specifications in plain text: 1000 mm steps, maximum length 6000 mm), further lengths on request

(6) Process connection (PA) ^a

750	TF 01	Temperature probe with stepped support tube	
752	TF 11	Temperature probe without support tube	
843	TA 02	Immersion tube with union nut and loose screw-connection ^b	
161	TA 03	Immersion tube with loose screw-connection	
847	TA 06	Immersion tube with displaceable clamping screw-connection on support tube ^b	
311	TA 20	Immersion tube with loose screw-connection and connection collar ^b	
872	TA 21	Immersion tube with loose screw-connection and sealing cone (only G 3/8 possible)	
873	TA 22	Immersion tube with loose pressure screw, sealing cone and loose screw-connection ^b	
401	TA 23	Immersion tube with pressure screw and contact pressure spring (only M 10x1 possible)	
913	SH 07	Screw-in sheath, multi-part, with clamping piece and locking screw (suitable for TF 01 and TF 11)	
820	SH 09	Weld-in sheath, multi-part, with clamping piece and locking screw ^b (not for FL 21 - welding collar with steel 1.4515)	
876	SH 10	Screw-in sheath, multi-part ^b (suitable for TA 21)	
871	SH 11	Screw-in sheath, multi-part ^b (suitable for TA 21)	

^a For the description and particularities refer to data sheet 60.8730.

^b Screw-in spigot as per DIN 3852, form A.

JUMO GmbH & Co. KG

Delivery address: Mackenrodtstraße 14,
36039 Fulda, Germany
Postal address: 36035 Fulda, Germany
Phone: +49 661 6003-0
Fax: +49 661 6003-607
E-mail: mail@jumo.net
Internet: www.jumo.net

JUMO Instrument Co. Ltd.

JUMO House
Temple Bank, Riverway
Harlow - Essex CM20 2DY, UK
Phone: +44 1279 63 55 33
Fax: +44 1279 63 52 62
E-mail: sales@jumo.co.uk
Internet: www.jumo.co.uk

JUMO Process Control, Inc.

8 Technology Boulevard
Canastota, NY 13032, USA
Phone: 315-697-JUMO
1-800-554-JUMO
Fax: 315-697-5867
E-mail: info@jumo.us
Internet: www.jumo.us

**Order
code****(7) Ø Process connection (PC) ^a**

6	6 mm
8	8 mm
10	10 mm
11	11 mm
12	12 mm

(8) Thread type of process connection (PA) ^a

000	Without thread (for TA 01 and TF 11)
103	Screw connection G 3/8
104	Screw-connection G 1/2
105	Screw-connection G 3/4
144	Screw-connection M 10 x 1 (only for TA 23)

(9) Material, probe / support tube ^a

26	Stainless steel (CrNi, 1.4571)
96	Copper (Cu) / Brass (CuZn) (up to 200°C)
95	Stainless steel (CrNi, 1.4571) - probe / Brass (CuZn) - support tube from 250°C)

(10) Material of process connection (PA) ^a

00	Without (only TF 01 and TF 11)
26	Stainless steel (CrNi, 1.4571)
46	Brass (CuZn)

(11) Fitting length, process connection (PA) ^a (dimension "EL" or "S")

0	Minimum fitting length TF 11 (active probe dimension)
50	50 mm
100	100 mm
150	150 mm
200	200 mm
...	Special length (specifications in plain text - 50 mm steps)

^a For the description and particularities refer to data sheet 60.8730.

JUMO GmbH & Co. KG

Delivery address: Mackenrodtstraße 14,
36039 Fulda, Germany
Postal address: 36035 Fulda, Germany
Phone: +49 661 6003-0
Fax: +49 661 6003-607
E-mail: mail@jumo.net
Internet: www.jumo.net

JUMO Instrument Co. Ltd.

JUMO House
Temple Bank, Riverway
Harlow - Essex CM20 2DY, UK
Phone: +44 1279 63 55 33
Fax: +44 1279 63 52 62
E-mail: sales@jumo.co.uk
Internet: www.jumo.co.uk

JUMO Process Control, Inc.

8 Technology Boulevard
Canastota, NY 13032, USA
Phone: 315-697-JUMO
1-800-554-JUMO
Fax: 315-697-5867
E-mail: info@jumo.us
Internet: www.jumo.us



Data sheet 60.8520

Page 11/11

Order code**(12) Switching output (SA)**

20 SA 20 One contact

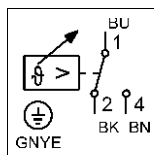

21 SA 21 Two contacts

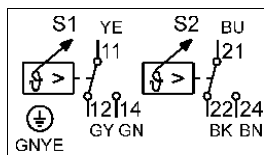

22 SA 22 Two contacts - Sequence switch

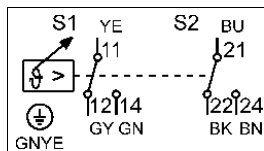
**(13) Extra codes (TZ)**

000	Without extra codes
430	Fly back (includes TZ 477)
426	Cover cap to protect the screw terminals against access and splashing water (standard for design 10 and 23; not for design 22; not in connection with TZ 460)
650	Micro switch 10 (3) A (AC/DC 230 V, +10/-15%, 48...63 Hz, $\cos \varphi = 1$ (0.6))
518	Stop for Min. — or Max. — set point value limitation, factory set
460	Device centering for panel cut-out 92 x 92 mm (only for basic type extension 2596)
477	Set point adjustment protected by the bolted cover. Adjustment with screwdriver.
401	Protection class IP 53 as per EN 60529, includes TZ 426 and TZ 477 (not for case Ø = 60 mm and front frame 72 x 72 mm; not for design 02 and 22)
522	Customized scale

Special versions on request !

Order code

(1) (2) (3) (4) (5) (6) (7) (8) (9) (10) (11) (12) (13)
608520 / - ... - .. - - ... - .. - ... - .. - ... - ... - ... / ... , ...

Order example

608520 / 2010 - 818 - 21 - 2000 - 104 - 10 - 000 - 26 - 00 - 100 - 20 / 650^a , ...

^a State extra codes one after another, separated by commas.

Stock versions

Part No.	Type	Display range °C	Switching output	Temperature probe, process connection	Immersion tube mm
60/00455918	608550/0180-643-874-8-106-50-150-20/434-522 with fly back	-20...+120	20 (1 contact)	TF 05 d = 8 mm	150
60/00455919	608550/0180-643-874-8-106-50-150-21/434-522 with fly back		21 (2 contacts)	TA 24, G 1", CuZn	

Delivery within 3 working days after receipt of order